

**UCFC**  
Cylindrical bore (with set screws)  
d 12 ~ 50 mm

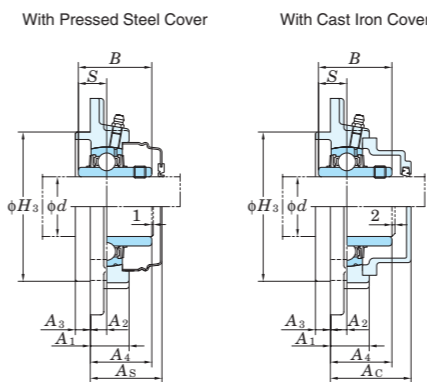
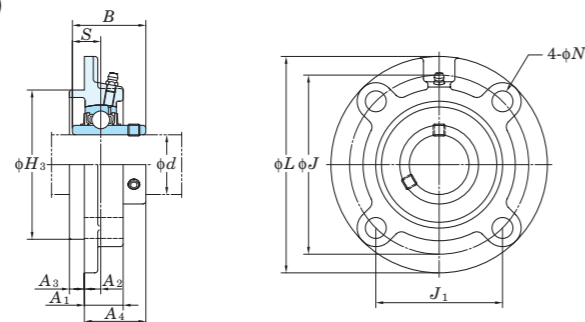

Variations of tolerance of spigot joint outside diameter ( $\Delta H_{3s}$ ), variations of tolerance of distance from mounting surface to center of spherical bore ( $\Delta A_{2s}$ ), tolerance of position of bolt hole (X), and tolerance of circumferential runout of spigot joint (Y)

Housing No.	$\Delta H_{3s}$	$\Delta A_{2s}$	X	Y
FC204-FC206 FCX05	0 -0.046	±0.5	0.7	0.2
FC207-FC210 FCX06-FCX10	0 -0.054			
FC211-FC217 FCX11-FCX15	0 -0.063	±0.8	1	0.3
FC218 FCX16-FCX18 FCX20	0 -0.072			0.4

Variations of tolerance of bolt hole diameter ( $\Delta N_s$ )

Housing No.	$\Delta N_s$
FC204-FC218   FCX05-FCX20	±0.2

Shaft Dia. mm inch	Dimensions inch mm											Bolt Size inch mm	Standard			Basic			With Pressed Steel Cover		With Cast Iron Cover					
	L	H <sub>3</sub>	J	J <sub>1</sub>	N	A <sub>1</sub>	A <sub>2</sub>	A <sub>3</sub>	A <sub>4</sub>	B	S		Unit No.	Housing No.	Bearing No.	Mass	Load Ratings kN	Factor	Unit No. Open Type	Unit No. Closed Type	Dimension mm inch	Mass	Unit No. Open Type	Unit No. Closed Type	Dimension mm inch	Mass
12 1/2																										
15 5/8	3 15/16	2.4409	3 5/64	2 11/64	15/32	13/16	25/64	13/64	1 1/8	1.220	0.500		FC204	UC201-8 UC202 UC202-10 UC203 UC204-12 UC204	0.78 0.78 0.76 0.75 0.75 0.73	12.8 6.65	13.2	UCFC201C UCFC201D UCFC202C UCFC202D UCFC203C UCFC203D UCFC204C UCFC204D	32 32 32	1 1/4	0.78 0.76 0.75 0.73					
17 3/4																										
20																										
25 7/8 15/16	4 17/32	2.7559	3 35/64	2 1/2	15/32	13/16	25/64	15/64	1 3/16	1.343	0.563		FC205	UC205-14 UC205-15 UC205 UC205-16	0.95 0.95 0.95 0.95	14.0 7.85	13.9	UCFC205C UCFC205D UCFC205FC UCFC205FD	34 34	1 11/32	0.95					
25 1																										
25 1	4 3/8	2.9921	3 3/8	2 9/16	3/8	15/16	25/64	15/64	1 9/32	1.500	0.626		FCX05	UCX05 UCX05-16	1.2 1.2	19.5 11.3	13.9	UCFCX05C UCFCX05D	36	1 13/32	1.2					
30 1 1/8	4 29/32	3.1496	3 15/16	2 25/32	15/32	29/32	25/64	5/16	1 9/32	1.500	0.626		FC206	UC206-18 UC206 UC206-19 UC206-20	1.3 1.3 1.3	19.5 11.3	13.9	UCFC206C UCFC206D UCFC206FC UCFC206FD	36	1 13/32	1.3					
30 1 3/16																										
30 1 1/4	5	3.3465	4 9/64	2 59/64	15/32	7/8	5/16	3/8	1 5/16	1.689	0.689		FCX06	UCX06 UCX06-19 UCX06-20	1.5 1.5 1.5	25.7 15.4	13.9	UCFCX06C UCFCX06D	38	1 1/2	1.5					
35 1 3/16																										
35 1 5/16	5 5/16	3.5433	4 21/64	3 1/16	35/64	1 1/32	7/16	5/16	1 7/16	1.689	0.689		FC207	UC207-20 UC207-21 UC207-22 UC207	1.7 1.7 1.7 1.7	25.7 15.4	13.9	UCFC207C UCFC207D UCFC207FC UCFC207FD	41	1 5/8	1.7					
35 1 3/8																										
35 1 7/16	5 1/4	3.6220	4 3/8	3 3/32	15/32	1 1/32	23/64	7/16	1 17/32	1.937	0.748		FCX07	UCX07-22 UCX07 UCX07-23	1.9 1.9 1.9	29.1 17.8	14.0	UCFCX07C UCFCX07D	43	1 11/16	1.9					
40 1 1/2	5 23/32	3.9370	4 23/32	3 11/32	35/64	1 1/32	7/16	25/64	1 5/8	1.937	0.748		FC208	UC208-24 UC208-25 UC208	2.0 2.0 2.0	29.1 17.8	14.0	UCFC208C UCFC208D	45	1 25/32	2.0					
40 1 9/16																										
40 1 1/2	5 1/4	3.6220	4 3/8	3 3/32	15/32	1 1/32	23/64	7/16	1 17/32	1.937	0.748		FCX08	UCX08-24 UCX08	2.0 2.0	34.1 21.3	14.0	UCFCX08C UCFCX08D	43	1 11/16	2.0					
45 1 5/8																										
45 1 11/16	6 5/16	4.1339	5 13/64	3 43/64	5/8	1 1/32	25/64	15/32	1 19/32	1.937	0.748		FC209	UC209-26 UC209-27 UC209-28 UC209	2.6 2.6 2.6 2.6	34.1 21.3	14.0	UCFC209C UCFC209D	44	1 23/32	2.6					
45 1 3/4																										
45 1 3/4	6 3/32	4.2520	5 1/8	3 5/8	35/64	31/32	5/16	15/32	1 19/32	2.031	0.748		FCX09	UCX09-28 UCX09	2.6 2.6	35.1 23.3	14.4	UCFCX09C UCFCX09D	45	1 25/32	2.6					
50 1 7/8																										
50 1 15/16	6 1/2	4.3307	5 7/16	3 27/32	5/8	1 3/32	25/64	15/32	1 11/16	2.031	0.748		FC210	UC210-30 UC210-31 UC210 UC210-32	2.9 2.9 2.9 2.9	35.1 23.3	14.4	UCFC210C UCFC210D	47	1 27/32	2.9					
50 2																										
50 1 15/16	6 3/8	4.6457	5 23/64	3 25/32	35/64	31/32	9/32	5/8	1 19/32	2.189	0.874		FCX10	UCX10-31 UCX10 UCX10-32	3.2 3.2 3.2	43.4 29.4	14.4	UCFCX10C UCFCX10D	45	1 25/32	3.2					
50 2																										

Remarks 1. In Part No. of unit and units with covers, fitting codes follow bore diameter numbers. (See Table 10.5 in P.51.)  
2. Part No. of applicable grease fittings are shown below.  
A-1/4-28UNF ..... 201-210, X05-X09  
A-R1/8 ..... 211-218, X10-X20

3. As for the triple seal type product (from 201 to 205 are the double seal type products), accessory code L3 (L2) follows the Part No. of unit or bearing. (Example of Part No. : UCFC206JL3, UC206L3)  
4. For the dimensions and forms of applicable bearings, see the dimensional tables of ball bearing for unit.  
5. Housings of nodular graphite cast iron are also available.